

Assembly Instructions

Standard Pull-Up Banners

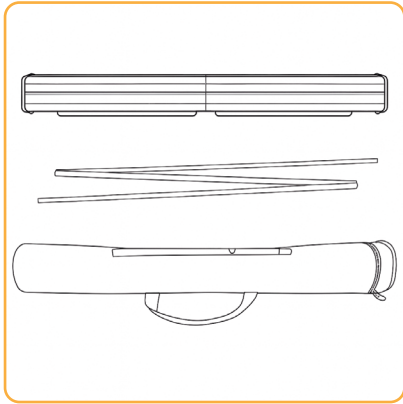

Step 1

Unpack your pull-up stand from the carry bag and lay out all the components on a flat surface.

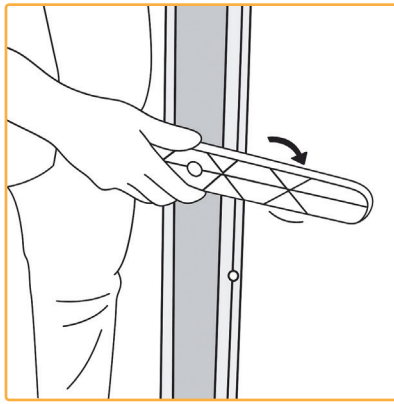

Step 2

Place the stand on the floor and rotate the feet 90 degrees so they're perpendicular to the base.

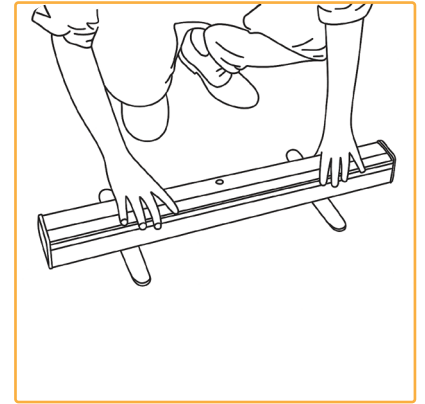

Step 3

Set the stand upright on the floor, ready for assembly.

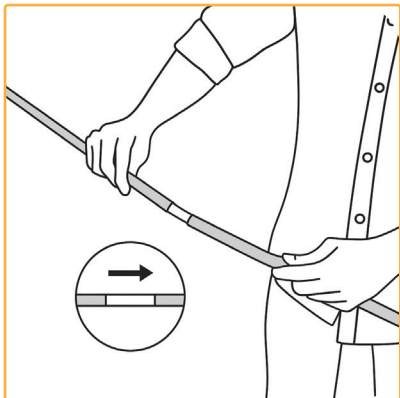

Step 4

Grab the folded three-section pole and connect the parts to form one long support pole.

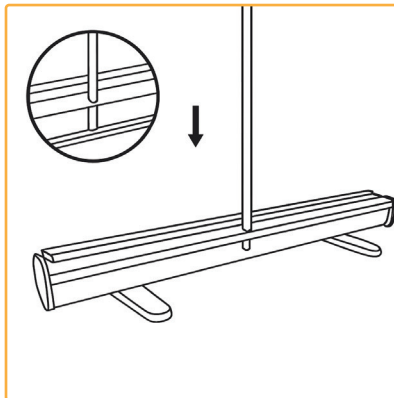

Step 5

Insert the assembled pole into the slot on the back of the base. Ensure it's securely fitted.

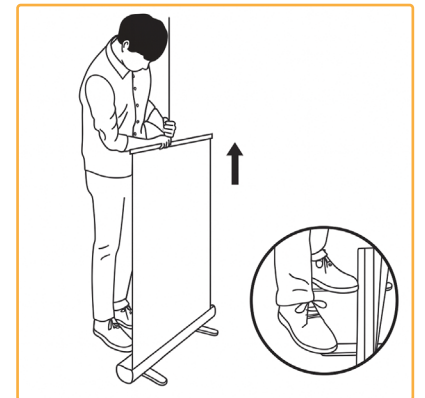

Step 6

While stepping on the base, slowly pull the banner up with one hand and hold the pole steady with the other.

Warning: Avoid letting the print touch the sides of the base, as this can cause creasing.

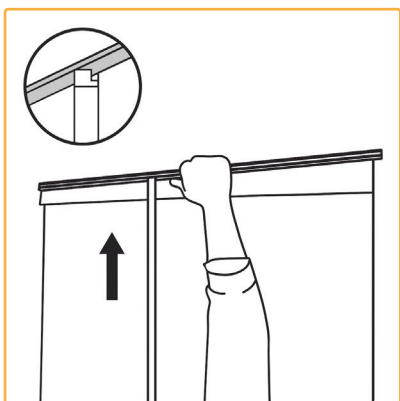

Step 7

Hook the top rail of the banner onto the pole's clip at the back and pull it straight.



Step 8

Your pull-up stand is now fully assembled and ready to display!

Note: If the print is not standing straight please pull the top rail forward or back to get it aligned.